

QWTLF Series Wall Mount LED Tower Lights

The QWTLF Series Wall Mount LED Tower Lights designed to reduce damage from moving equipment while enhancing visibility with a circular lens and direct light distribution. Available in one to five layers with a built-in buzzer. These lights are ideal for signaling and alarms in automation control applications.

Features and Specifications:

- **Connection type:** Cable, 400mm leads
- **Ambient operating temperature:** -30°C to +50°C
- **Operation mode:** Fixed or Flashing
- **Flashing rate:** 60-80 flashes/min
- **Sound Volume:** Max. 85dB at 1m
- **Rated Voltage:** 24VDC
- **Materials:** Lens: PC | Housing: ABS
- **IP rating:** IP54
- **Approvals:** cULus (#E311924)



QWTLF Series Wall Mount LED Tower Lights (Order by Part No.)

Layer	1	2	3	4	5
Colour	Red	Red, Green	Red, Amber, Green	Red, Amber, Green, Blue	Red, Amber, Green, Blue, White
Part No.	QT-QWTLF-BZ-1-24-R	QT-QWTLF-BZ-2-24-RG	QT-QWTLF-BZ-3-24-RAG	QT-QWTLF-BZ-4-24-RAGB	QT-QWTLF-BZ-5-24-RAGBW

*Other voltage options (without UL approval) available for special order, consult ITC for more information
Information subject to change without notice

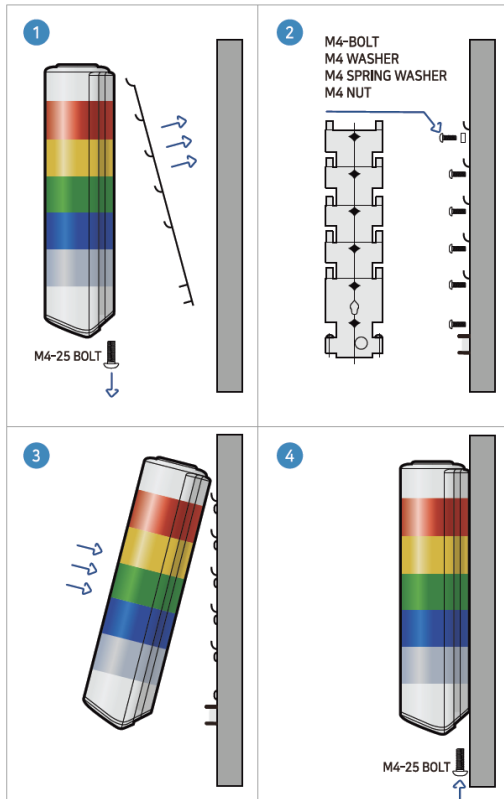

Mounting Bracket Installation

1. Loosen the two M4 bolts on the bottom of the bracket and remove the body
2. Attach the bracket to the wall with screws into the mounting holes
3. Hang the unit onto the bracket
4. After attaching the unit to the bracket, secure the two pieces together with the M4 bolts at the bottom of the product

Dimensions (mm)

